



**Installation and abutment selection guide for IPD's Interface library for Exocad.**

## Table of contents

1. Installation
2. Important recommendations
3. How to use the Scan Body
4. Library structure
  1. Standard Interfaces
  2. Wide Platform Interfaces
  3. Multiunit Interfaces
  4. Straumann® Tissue Level® Regular Neck
  5. Klockner® Essential® Regular Platform

# 1. Installation

## STEP 1

If you are downloading the library from Spain:

Download the library by filling the library form request from

<https://ipd2004.com/library/>

If you want to download the library from outside Spain, please contact your local distributor.

# 1. Installation

## STEP 2: Local hard drive (C:)

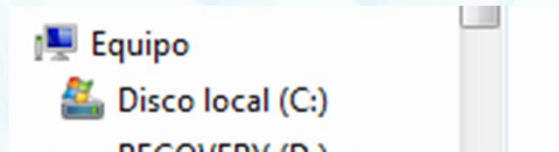

Info: possible folder name.  
*May change in each case.*

## STEP 3: Folder *Program files (x86) / Program files*

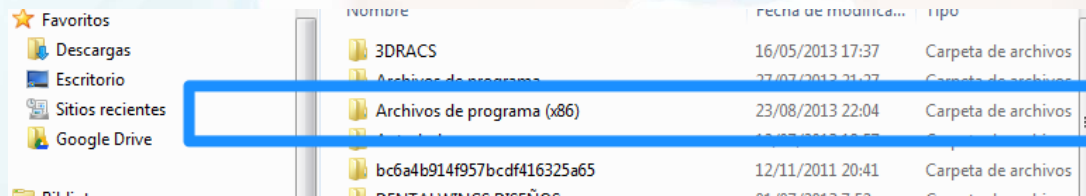

## STEP 4: Folder *Exocad DentalCAD*

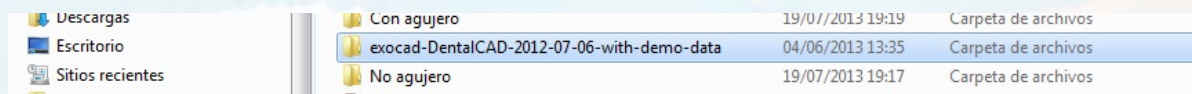

# 1. Installation

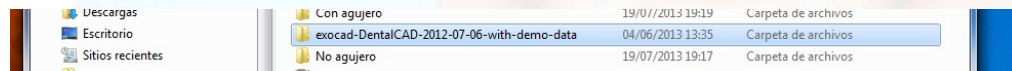

## STEP 5: Content Folder Exocad DentalCAD



## STEP 6: Content *DentalCADApp*

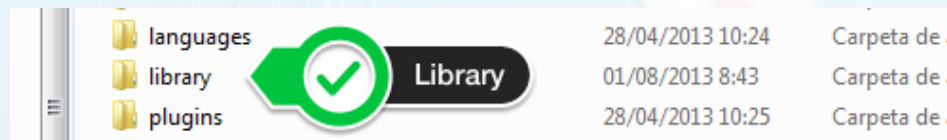
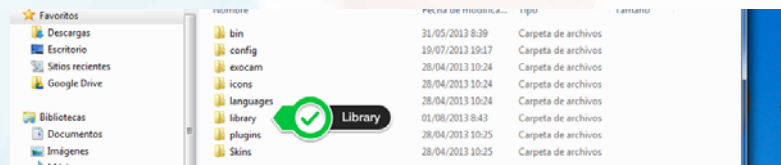

# 1. Installation

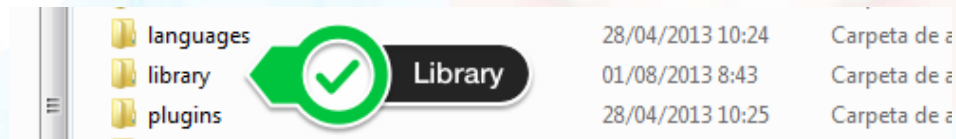

STEP 7: Content Folder library

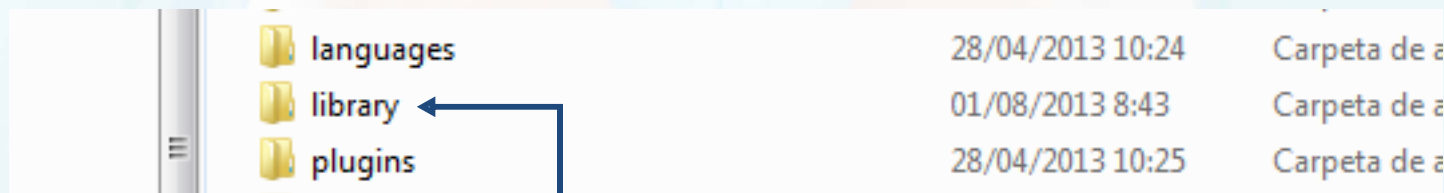

STEP 8: Select folder Ipd2004 Library and copy it into the folder *implant*

# 1. Installation

Display of the imported Ipd2004 Library in *the Wizard selection menu.*

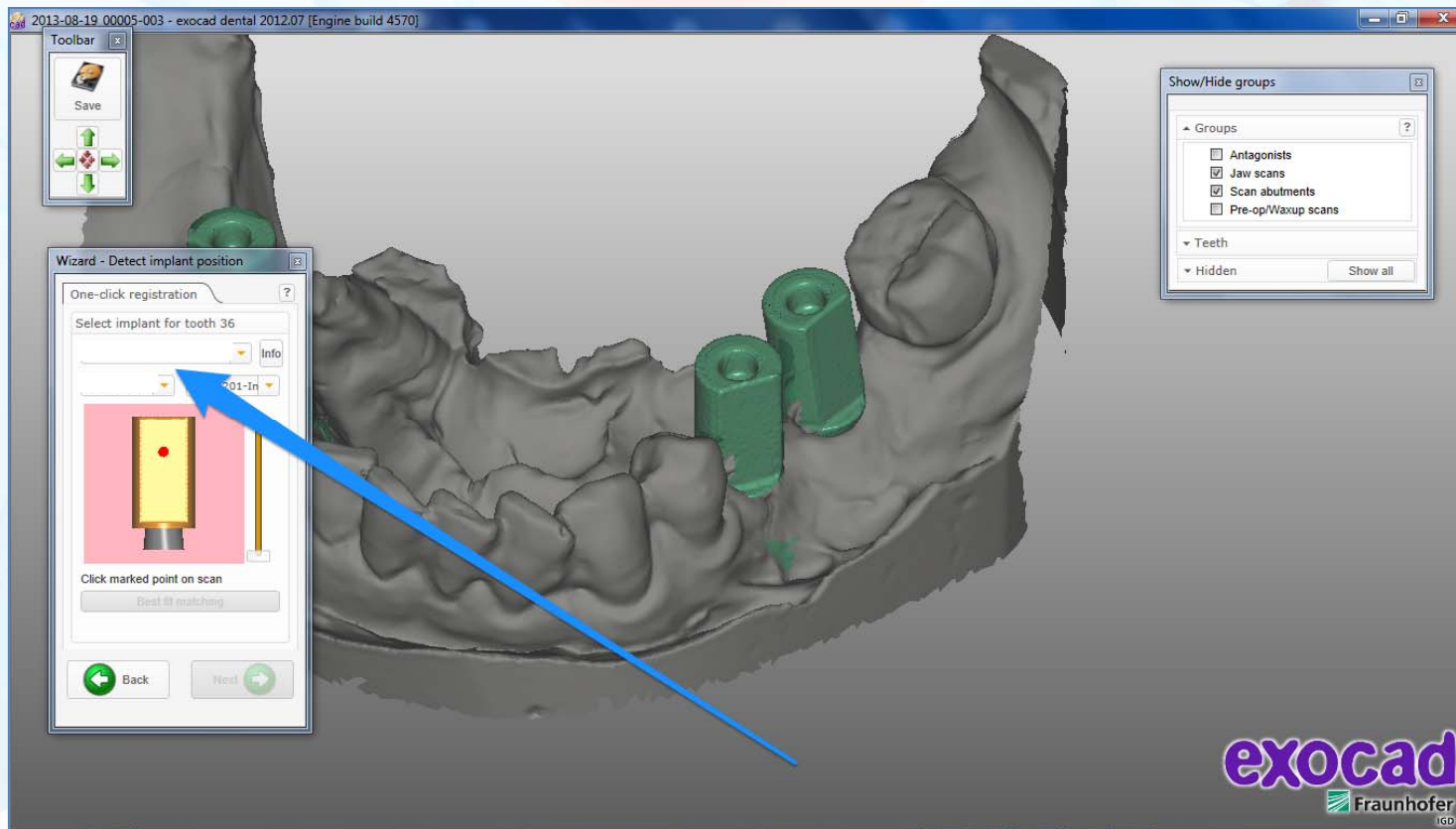

## 2. Important recommendations

Interfaces are made of grade 5 Titanium. Standard Titanium-Titanium, Titanium-Zirconia, Titanium-CoCr cements can be used depending on the material used to make the crown.

Sandblasting of the interface prior to the bonding is not required, use instead hot steam to clean the bonding area.

Use always milling burs in good conditions. A milling bur with excessive wear may lead to a misfit between the interface abutment and the crown.

If you use ball nose end milling tools use only tools with a ball diameter  $\leq 0,6\text{mm}$ . If tools with a diameter  $> 0,6\text{mm}$  are used the crown may not fit on the interface.



### 3. How to use the Scan Body

IPD interface system uses only 3 types of scan bodies to cover all the range of connections and platforms (engaging, non engaging and multiunit type).

For scanning is required to use an interface as “connection converter”. Scan body is placed on top of the interface and hold together with a hollow screw (included with the scan body).

To tighten the hollow screw an IPD/KA-CI-09 screwdriver is required.

## 4. Library structure

When selecting the abutments of the IPD Interface System you will find the following options:

1. **Standard Interfaces**  
*Interfaces with standard supraconnection*
2. **Wide Platform Interfaces**  
*Interfaces with wide supraconnection base*
3. **MU Interfaces**  
*Interfaces for Multiunit abutments*
4. **TL RN**  
*Interfaces for Straumann Tissue Level Regular Neck*
5. **KL E RP**  
*Interfaces for Klockner Essential Regular Platform*

# 4.1. Standard Interfaces

## a. ENGAGING RESTORATIONS WITH HOLLOW SCREW:

For designing on engaging Interfaces with standard supraconnection using the Hollow Screw system, choose:

- Standard Interfaces > Engaging with Hollow Screw

### COMPATIBILITIES

STANDARD INTERFACES (WITH/WITHOUT HOLLOW SCREW) ENGAGING			
IPD/AA-IN-(00/02)	Nobel Biocare® Branemark® Ø3.3	IPD/EA-IW-(00/02)	Astra® Osseospeed™ Ø4.5/5.0
IPD/AA-IR-(00/02/04)	Nobel Biocare® Branemark® Ø4.1	IPD/FA-IN-(00/02)	Zimmer® External Hex Ø3.7
	BTI® External Hex Ø4.1	IPD/FA-IR-(00/02/04)	Zimmer® External Hex Ø4.5
IPD/AC-IN-(00/02)	Sweden & Martina® External Hex	IPD/GA-IN-(00/02)	BTI® External Hex Ø3.5
	Phibo® TSH® S3-S4	IPD/GB-IR-(00/02/04)	BTI® Interna (Universal Ø4.1 / Wide Ø5.5)
IPD/AC-IR-(00/02/04)	Nobel Biocare® Replace Select® Ø3.5	IPD/IA-IN-00	Dentsply Friadent® Xive® Ø3.4
IPD/AD-IN-(00/02)	Nobel Biocare® Replace Select® Ø4.3	IPD/IA-IR-00	Dentsply Friadent® Xive® Ø3.8
IPD/AD-IR-(00/02)	Nobel Biocare® Nobel Active® Ø3.5	IPD/IA-IW-00	Dentsply Friadent® Xive® Ø4.5
IPD/BA-IN-(00/02)	Nobel Biocare® Nobel Active® Ø4.3	IPD/IB-IN-(00/02)	Dentsply Friadent® Ankylos® C/X
IPD/BB-IN-(00/02)	Biomet 3i® External Hex Ø3.25	IPD/JA-IN-00	Camlog® Camlog System® Ø3.3
IPD/BB-IR-(00/02/04)	Biomet 3i® Certain Ø3.4	IPD/JA-IR-00	Camlog® Camlog System® Ø3.8
IPD/DB-IN-(00/02)	Biomet 3i® Certain Ø4.1	IPD/JA-IW-00	Camlog® Camlog System® Ø4.3
IPD/DB-IR-(00/02)	Bone Level® Ø3.3	IPD/LB-IN-00	Biohorizons® Tapered Internal Ø3.5
IPD/EA-IN-(00/02)	Bone Level® Ø4.1	IPD/LB-IR-00	Biohorizons® Tapered Internal Ø4.5
IPD/EA-IR-(00/02)	Astra® Osseospeed™ Ø3.0	IPD/MB-IN-00	Sweden & Martina® Premium Kohno® Ø3.8
	Astra® Osseospeed™ Ø3.5/4.0	IPD/MB-IR-00	Sweden & Martina® Premium Kohno® Ø4.25



# 4.1. Standard Interfaces

## b. ENGAGING RESTORATIONS WITHOUT HOLLOW SCREW:

For designing on engaging Interfaces with standard supraconnection without using the Hollow Screw system, choose:

- Standard Interfaces > Engaging without Hollow Screw

### COMPATIBILITIES

STANDARD INTERFACES (WITH/WITHOUT HOLLOW SCREW) ENGAGING			
IPD/AA-IN-(00/02)	Nobel Biocare® Branemark® Ø3.3	IPD/EA-IW-(00/02)	Astra® Osseospeed™ Ø4.5/5.0
IPD/AA-IR-(00/02/04)	Nobel Biocare® Branemark® Ø4.1	IPD/FA-IN-(00/02)	Zimmer® External Hex Ø3.7
	BTI® External Hex Ø4.1	IPD/FA-IR-(00/02/04)	Zimmer® External Hex Ø4.5
IPD/AC-IN-(00/02)	Sweden & Martina® External Hex	IPD/GA-IN-(00/02)	BTI® External Hex Ø3.5
	Phibo® TSH® S3-S4	IPD/GB-IR-(00/02/04)	BTI® Interna (Universal Ø4.1 / Wide Ø5.5)
IPD/AC-IR-(00/02/04)	Nobel Biocare® Replace Select® Ø3.5	IPD/IA-IN-00	Dentsply Friadent® Xive® Ø3.4
IPD/AD-IN-(00/02)	Nobel Biocare® Replace Select® Ø4.3	IPD/IA-IR-00	Dentsply Friadent® Xive® Ø3.8
IPD/AD-IR-(00/02)	Nobel Biocare® Nobel Active® Ø3.5	IPD/IA-IW-00	Dentsply Friadent® Xive® Ø4.5
IPD/BA-IN-(00/02)	Nobel Biocare® Nobel Active® Ø4.3	IPD/IB-IN-(00/02)	Dentsply Friadent® Ankylos® C/X
IPD/BB-IN-(00/02)	Biomet 3i® External Hex Ø3.25	IPD/JA-IN-00	Camlog® Camlog System® Ø3.3
IPD/BB-IR-(00/02/04)	Biomet 3i® Certain Ø3.4	IPD/JA-IR-00	Camlog® Camlog System® Ø3.8
IPD/DB-IN-(00/02)	Biomet 3i® Certain Ø4.1	IPD/JA-IW-00	Camlog® Camlog System® Ø4.3
IPD/DB-IR-(00/02)	Bone Level® Ø3.3	IPD/LB-IN-00	Biohorizons® Tapered Internal Ø3.5
IPD/EA-IN-(00/02)	Bone Level® Ø4.1	IPD/LB-IR-00	Biohorizons® Tapered Internal Ø4.5
IPD/EA-IR-(00/02)	Astra® Osseospeed™ Ø3.0	IPD/MB-IN-00	Sweden & Martina® Premium Kohno® Ø3.8
	Astra® Osseospeed™ Ø3.5/4.0	IPD/MB-IR-00	Sweden & Martina® Premium Kohno® Ø4.25



# 4.1. Standard Interfaces

## c. NON-ENGAGING RESTORATIONS WITH HOLLOW SCREW:

For designing on non-engaging Interfaces with standard supraconnection using the Hollow Screw system, choose:

- Standard Interfaces > Non-engaging with Hollow Screw

### COMPATIBILITIES

STANDARD INTERFACES (WITH/WITHOUT HOLLOW SCREW) NON-ENGAGING			
IPD/AA-IN-(01/03)	Nobel Biocare® Branemark® Ø3.3	IPD/EA-IW-(01/03)	Astra® Osseospeed™ Ø4.5/5.0
IPD/AA-IR-(01/03/05)	Nobel Biocare® Branemark® Ø4.1	IPD/FA-IN-(01/03)	Zimmer® External Hex Ø3.7
	BTI® External Hex Ø4.1	IPD/FA-IR-(01/03/05)	Zimmer® External Hex Ø4.5
IPD/AC-IN-(01/03)	Sweden & Martina® External Hex	IPD/GA-IN-(01/03)	BTI® External Hex Ø3.5
	Phibo® TSH® S3-S4	IPD/GB-IR-(01/03/05)	BTI® Interna (Universal Ø4.1 / Wide Ø5.5)
IPD/AC-IR-(01/03/05)	Nobel Biocare® Replace Select® Ø3.5	IPD/IA-IN-01	Dentsply Friadent® Xive® Ø3.4
IPD/AD-IN-(01/03)	Nobel Biocare® Replace Select® Ø4.3	IPD/IA-IR-01	Dentsply Friadent® Xive® Ø3.8
	Nobel Biocare® Nobel Active® Ø3.5	IPD/IA-IW-01	Dentsply Friadent® Xive® Ø4.5
IPD/AD-IR-(01/03)	Nobel Biocare® Nobel Active® Ø4.3	IPD/IB-IN-(01/03)	Dentsply Friadent® Ankylos® C/X
IPD/BA-IN-(01/03)	Biomet 3i® External Hex Ø3.25	IPD/JA-IN-01	Camlog® Camlog System® Ø3.3
IPD/BB-IN-(01/03)	Biomet 3i® Certain Ø3.4	IPD/JA-IR-01	Camlog® Camlog System® Ø3.8
IPD/BB-IR-(01/03/05)	Biomet 3i® Certain Ø4.1	IPD/JA-IW-01	Camlog® Camlog System® Ø4.3
IPD/DB-IN-(01/03)	Bone Level® Ø3.3	IPD/LB-IN-01	Biohorizons® Tapered Internal Ø3.5
IPD/DB-IR-(01/03)	Bone Level® Ø4.1	IPD/LB-IR-01	Biohorizons® Tapered Internal Ø4.5
IPD/EA-IN-(01/03)	Astra® Osseospeed™ Ø3.0	IPD/MB-IN-01	Sweden & Martina® Premium Kohno® Ø3.8
IPD/EA-IR-(01/03)	Astra® Osseospeed™ Ø3.5/4.0	IPD/MB-IR-01	Sweden & Martina® Premium Kohno® Ø4.25



# 4.1. Standard Interfaces

## d. NON-ENGAGING RESTORATIONS WITHOUT HOLLOW SCREW:

For designing on non-engaging Interfaces with standard supraconnection without using the Hollow Screw system, choose:

- Standard Interfaces > Non-engaging without Hollow Screw

### COMPATIBILITIES

STANDARD INTERFACES (WITH/WITHOUT HOLLOW SCREW) NON-ENGAGING			
IPD/AA-IN-(01/03)	Nobel Biocare® Branemark® Ø3.3	IPD/EA-IW-(01/03)	Astra® Osseospeed™ Ø4.5/5.0
IPD/AA-IR-(01/03/05)	Nobel Biocare® Branemark® Ø4.1	IPD/FA-IN-(01/03)	Zimmer® External Hex Ø3.7
	BTI® External Hex Ø4.1	IPD/FA-IR-(01/03/05)	Zimmer® External Hex Ø4.5
IPD/AC-IN-(01/03)	Sweden & Martina® External Hex	IPD/GA-IN-(01/03)	BTI® External Hex Ø3.5
	Phibo® TSH® S3-S4	IPD/GB-IR-(01/03/05)	BTI® Interna (Universal Ø4.1 / Wide Ø5.5)
IPD/AC-IR-(01/03/05)	Nobel Biocare® Replace Select® Ø3.5	IPD/IA-IN-01	Dentsply Friadent® Xive® Ø3.4
IPD/AD-IN-(01/03)	Nobel Biocare® Replace Select® Ø4.3	IPD/IA-IR-01	Dentsply Friadent® Xive® Ø3.8
	Nobel Biocare® Nobel Active® Ø3.5	IPD/IA-IW-01	Dentsply Friadent® Xive® Ø4.5
IPD/AD-IR-(01/03)	Nobel Biocare® Nobel Active® Ø4.3	IPD/IB-IN-(01/03)	Dentsply Friadent® Ankylos® C/X
IPD/BA-IN-(01/03)	Biomet 3i® External Hex Ø3.25	IPD/JA-IN-01	Camlog® Camlog System® Ø3.3
IPD/BB-IN-(01/03)	Biomet 3i® Certain Ø3.4	IPD/JA-IR-01	Camlog® Camlog System® Ø3.8
IPD/BB-IR-(01/03/05)	Biomet 3i® Certain Ø4.1	IPD/JA-IW-01	Camlog® Camlog System® Ø4.3
IPD/DB-IN-(01/03)	Bone Level® Ø3.3	IPD/LB-IN-01	Biohorizons® Tapered Internal Ø3.5
IPD/DB-IR-(01/03)	Bone Level® Ø4.1	IPD/LB-IR-01	Biohorizons® Tapered Internal Ø4.5
IPD/EA-IN-(01/03)	Astra® Osseospeed™ Ø3.0	IPD/MB-IN-01	Sweden & Martina® Premium Kohno® Ø3.8
IPD/EA-IR-(01/03)	Astra® Osseospeed™ Ø3.5/4.0	IPD/MB-IR-01	Sweden & Martina® Premium Kohno® Ø4.25



## 4.2. Wide Platform Interfaces

### a. ENGAGING RESTORATIONS WITH HOLLOW SCREW:

For designing on engaging wide platform Interfaces using the Hollow Screw system, choose:

- Wide Platform Interfaces > Engaging with Hollow Screw

### COMPATIBILITIES

#### WIDE PLATFORM (WITH/WITHOUT HOLLOW SCREW) ENGAGING

IPD/AC-IW-(00/02/04)	Nobel Biocare® Replace Select® ø5.0
IPD/BA-IW-(00/02/04)	Biomet 3i® Hexágono Externo ø5.1
IPD/BB-IW-(00/02/04)	Biomet 3i® Certain® ø5.0
IPD/GA-IW-00	BTI® Hexágono Externo ø5.5



## 4.2. Wide Platform Interfaces

### b. ENGAGING RESTORATIONS WITHOUT HOLLOW SCREW:

For designing on engaging wide platform Interfaces without using the Hollow Screw system, choose:

- Wide Platform Interfaces > Engaging without Hollow Screw

### COMPATIBILITIES

#### WIDE PLATFORM (WITH/WITHOUT HOLLOW SCREW) ENGAGING

IPD/AC-IW-(00/02/04)	Nobel Biocare® Replace Select® $\varnothing$ 5.0
IPD/BA-IW-(00/02/04)	Biomet 3i® Hexágono Externo $\varnothing$ 5.1
IPD/BB-IW-(00/02/04)	Biomet 3i® Certain® $\varnothing$ 5.0
IPD/GA-IW-00	BTI® Hexágono Externo $\varnothing$ 5.5





## 4.2. Wide Platform Interfaces

### c. NON-ENGAGING RESTORATIONS WITH HOLLOW SCREW:

For designing on non-engaging wide platform Interfaces using the Hollow Screw system, choose:

- Wide Platform Interfaces > Non-engaging with Hollow Screw

### COMPATIBILITIES

#### WIDE PLATFORM (WITH/WITHOUT HOLLOW SCREW) NON-ENGAGING

IPD/AC-IW-(01/03/05)	Nobel Biocare® Replace Select® ø5.0
IPD/BA-IW-(01/03/05)	Biomet 3i® Hexágono Externo ø5.1
IPD/BB-IW-(01/03/05)	Biomet 3i® Certain® ø5.0
IPD/GA-IW-01	BTI® Hexágono Externo ø5.5



## 4.2. Wide Platform Interfaces

### d. NON-ENGAGING RESTORATIONS WITHOUT HOLLOW SCREW:

For designing on non-engaging wide platform Interfaces without using the Hollow Screw system, choose:

- Wide Platform Interfaces > Non-engaging without Hollow Screw

### COMPATIBILITIES

#### WIDE PLATFORM (WITH/WITHOUT HOLLOW SCREW) NON-ENGAGING

IPD/AC-IW-(01/03/05)	Nobel Biocare ® Replace Select® ø5.0
IPD/BA-IW-(01/03/05)	Biomet 3i® Hexágono Externo ø5.1
IPD/BB-IW-(01/03/05)	Biomet 3i® Certain® ø5.0
IPD/GA-IW-01	BTI® Hexágono Externo ø5.5



## 4.3. MU Interfaces

### a. NON-ENGAGING RESTORATIONS WITH HOLLOW SCREW:

For designing on multiunit Interfaces using the Hollow Screw system, choose:

- MU interfaces > Non-engaging with Hollow Screw

#### COMPATIBILITIES

MULTIUNIT (WITH/WITHOUT HOLLOW SCREW) NON-ENGAGING	
IPD/AB-IR-01	Multiunit

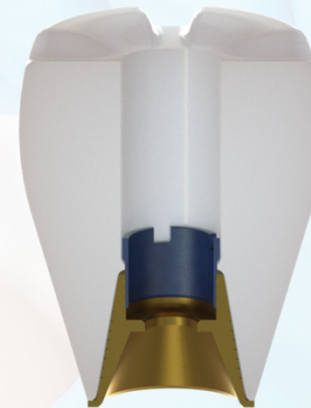

## 4.3. MU Interfaces

### b. NON-ENGAGING RESTORATIONS WITHOUT HOLLOW SCREW:

For designing on multiunit Interfaces without using the Hollow Screw system, choose:

- MU interfaces > Non-engaging without *Hollow Screw*

#### COMPATIBILITIES

MULTIUNIT (WITH/WITHOUT HOLLOW SCREW) NON-ENGAGING	
IPD/AB-IR-01	Multiunit

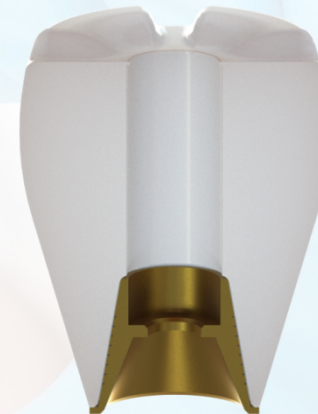

## 4.4. TL RN

### a. ENGAGING RESTORATIONS WITH HOLLOW SCREW:

For designing on engaging Straumann® Tissue Level® Regular Neck Interfaces using the Hollow Screw system, choose:

- TL RN > Engaging with Hollow Screw

### COMPATIBILITIES

TISSUE LEVEL® (WITH/WITHOUT HOLLOW SCREW) ENGAGING

IPD/DA-IR-00

Tissue Level® Ø4.8



## 4.4. TL RN

### b. ENGAGING RESTORATIONS WITHOUT HOLLOW SCREW:

For designing on engaging Straumann® Tissue Level® Regular Neck Interfaces without using the Hollow Screw system, choose:

- TL RN > Engaging without Hollow Screw

### COMPATIBILITIES

TISSUE LEVEL® (WITH/WITHOUT HOLLOW SCREW) ENGAGING

IPD/DA-IR-00

Tissue Level® Ø4.8



## 4.4. TL RN

### c. NON-ENGAGING RESTORATIONS WITH HOLLOW SCREW:

For designing on non-engaging Straumann® Tissue Level® Regular Neck Interfaces using the Hollow Screw system, choose:

- TL RN > Non-engaging with Hollow Screw

### COMPATIBILITIES

#### TISSUE LEVEL® (WITH/WITHOUT HOLLOW SCREW) NON-ENGAGING

IPD/DA-IR-01

Tissue Level® Ø4.8 (implant level)

IPD/DA-IR-11

Tissue Level® Ø4.8 (Synocta® level)



## 4.4. TL RN

### d. NON-ENGAGING RESTORATIONS WITHOUT HOLLOW SCREW:

For designing on non-engaging Straumann® Tissue Level® Regular Neck Interfaces without using the Hollow Screw system, choose:

- TL RN > Non-engaging without Hollow Screw

### COMPATIBILITIES

#### TISSUE LEVEL® (WITH/WITHOUT HOLLOW SCREW) NON-ENGAGING

IPD/DA-IR-01

Tissue Level® Ø4.8 (sobre implante)

IPD/DA-IR-11

Tissue Level® Ø4.8 (Synocta®)





## 4.5. KL E RP

### a. ENGAGING RESTORATIONS WITH HOLLOW SCREW:

For designing on engaging Klockner® Essential® Regular Platform Interfaces using the Hollow Screw system, choose:

- KL E RP > Engaging with Hollow Screw

### COMPATIBILITIES

KLOCKNER® ESSENTIAL® (WITH/WITHOUT HOLLOW SCREW) ENGAGING

IPD/CB-IR-00

Klockner® Essential® Ø4.5



## 4.5. KL E RP

### b. ENGAGING RESTORATIONS WITHOUT HOLLOW SCREW:

For designing on engaging Klockner® Essential® Regular Platform Interfaces without using the Hollow Screw system, choose:

- KL E RP > Engaging without Hollow Screw

### COMPATIBILITIES

KLOCKNER® ESSENTIAL® (WITH/WITHOUT HOLLOW SCREW) ENGAGING

IPD/CB-IR-00

Klockner® Essential® Ø4.5



## 4.5. KL E RP

### c. NON-ENGAGING RESTORATIONS WITH HOLLOW SCREW:

For designing on non-engaging Klockner® Essential® Regular Platform Interfaces using the Hollow Screw system, choose:

- KL E RP > Non-engaging with Hollow Screw

### COMPATIBILITIES

KLOCKNER® ESSENTIAL® (WITH/WITHOUT HOLLOW SCREW) NON-ENGAGING

IPD/CB-IR-01

Klockner® Essential® Ø4.5



## 4.5. KL E RP

### d. NON-ENGAGING RESTORATIONS WITHOUT HOLLOW SCREW:

For designing on non-engaging Klockner® Essential® Regular Platform Interfaces without using the Hollow Screw system, choose:

- KL E RP > Non-engaging without Hollow Screw

### COMPATIBILITIES

KLOCKNER® ESSENTIAL® (WITH/WITHOUT HOLLOW SCREW) NON-ENGAGING

IPD/CB-IR-01

Klockner® Essential® Ø4.5





Camí del Mig, 71  
08302 Mataró (Barcelona)  
Phone: 93 193 10 67  
Fax: (+34) 93 757 18 44  
[export@ipd2004.com](mailto:export@ipd2004.com)  
[www.ipd2004.com](http://www.ipd2004.com)